

SCL K07/ K08 / K09 / K10
MS - SERIES

TECHNICAL CHARACTERISTICS

- Aluminium alloy construction
- Smooth operation
- High efficiency impeller
- Maintenance free
- Mountable in any position
- Recognized TEFC - cURus motor

OPTIONS

- Special voltages (IEC 38)
- Surface treatments

ACCESSORIES

- Inlet and/or inline filters
- Additional inlet/outlet silencers
- Safety valves
- Flow converting device
- Optional connectors

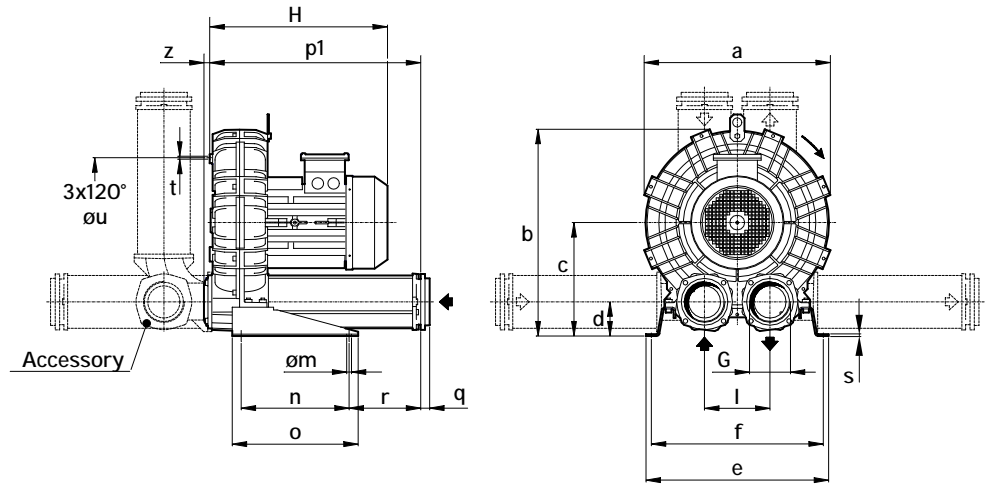

Dimensions in inches.
Dimension for reference only.

Model	a	b	c	d	e	f	G	l	m	n	o	p1	q	r	s	t	u	z
K07-MS	16.69	18.84	10.59	3.23	18.43	17.24	3" NPT	6.10	0.51	11.81	13.78	20.16	0.98	5.39	0.20	M8	11.61	0.63
K08-MS	17.99	19.61	10.59	3.23	18.82	17.64	3" NPT	6.10	0.51	11.81	13.78	20.16	0.98	5.39	0.20	M8	12.2	0.63
K09-MS	19.37	22.09	12.40	3.78	20.00	18.82	4" NPT	7.17	0.51	11.81	13.78	23.07	0.98	7.83	0.20	M8	14.17	0.63
K10-MS	20.31	22.56	12.40	3.78	20.00	18.82	4" NPT	7.17	0.51	11.81	13.78	23.07	0.98	7.83	0.20	M8	14.17	0.63

Model	Maximum flow cfm 60 Hz 3500 rpm	Installed power Hp	Maximum differential pressure Δp (In Hg)	Noise level Lp dB (A) (1)	Overall dimensions	Weight
					H	
					Inches	
K07-MS	294	4	3.0	77.7	15.6	116.2
		5 1/2	5.6	78.0	16.3	119.0
		7 1/2	8.9	78.3	18.4	160.5
		10	10.3	78.6	19.1	172.6
K08-MS	381	5 1/2	3.0	78.8	16.3	124.8
		7 1/2	5.2	79.1	18.4	166.5
		10	8.1	79.4	19.1	179.0
		15	9.6	79.7	19.1	192.0
K09-MS	471	7 1/2	3.7	79.3	18.8	186.3
		10	5.9	79.6	19.5	245.0
		15	9.6	80.1	22.0	212.0
K10-MS	556	7 1/2	2.4	79.4	18.8	189.6
		10	4.4	79.7	19.5	202.0
		15	8.1	80.2	19.6	215.0
		20	9.6	80.5	22.0	248.0

(1) Noise measured at 1 m distance with inlet and outlet ports piped, in accordance to ISO 3744.

- For proper use, the blower should be equipped with inlet filter and safety valve; other accessories available on request.
- Ambient temperature from +5° to +104°F.
- Specifications subject to change without notice.



LEGENDS EQUIPMENT

REGENERATIVE BLOWERS - VACUUM
SCL K07 / K08 / K09 / K10
MS SERIES

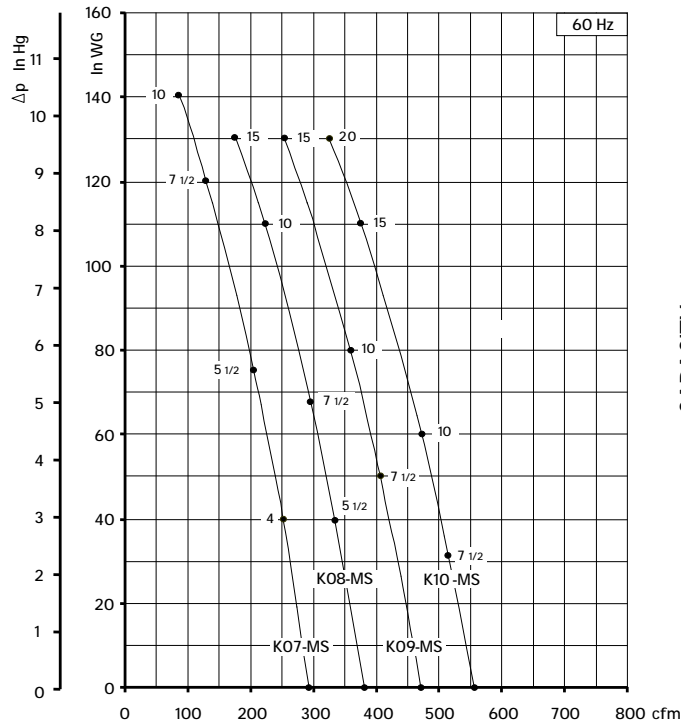

CAPACITY

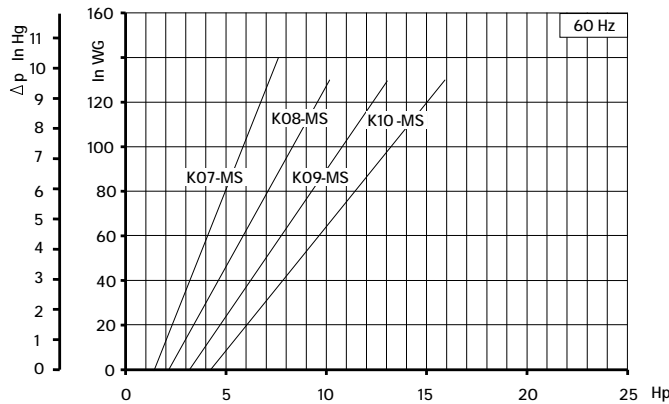

ABSORBED POWER

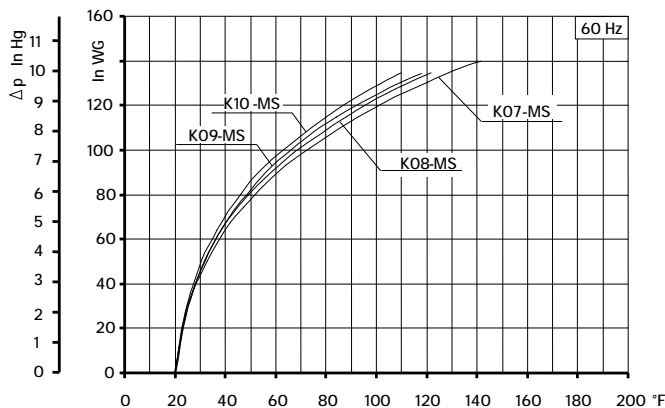

TEMPERATURE INCREASE

Curves refer to air at 68° F temperature, measured at inlet port and 29.92 In Hg atmospheric backpressure (abs).
Values for flow, power consumption and temperature rise: +/-10% tolerance.
Data subject to change without notice.