

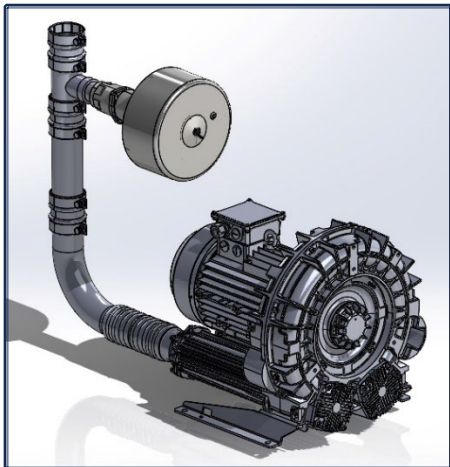

# LL06-MS-6 VACUUM PACKAGE

L Series Regenerative Vacuum



## Model L06-MS

### Standard Features

- Premium Efficient Motor
- High efficiency impeller
- Mount in any position
- Maintenance free operation
- TEFC (IP55) Motor

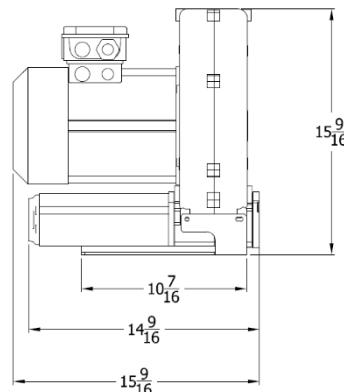
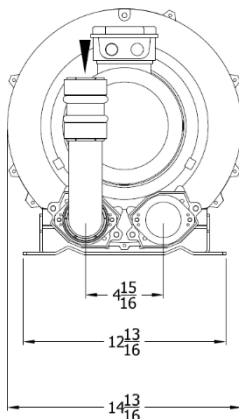

## Technical Specifications

Model No.	HP	Hz	Open Flow (cfm)	Max Vacuum in. HG	Connection	Voltage	dB(A) <sup>2</sup>	Weight (lb)
<b>L 06-MS-5.5-3</b>	5.5	60	216	8.1	2" NPT	208-230/460	72.6	86
		50	179	8.1	2" NPT	200/400	70.6	

Motors include normally closed thermal protector, 1.15 S.F. (60 Hz), tropicalized windings, Class F (B) insulation, and are suitable for use with a VFD (Contact Legends for pneumatic and speed limits when used with a VFD).

Noise level measured at a distance of 1 m with inlet and outlet ports piped in accordance to ISO 3744  
Data is subject to change without notice.





## STANDARD PACKAGE COMPONENTS

	PART #	QTY	DESCRIPTION
1	L06-MS-6	1	5.5 Horsepower Regenerative vacuum unit. 230/460/3/60 TEFC
2	20-HO-4119	1	2" Dia. x 8" long flex connection
	20-Z-AC-4030	2	2" Dia. hose clamp. Spiral power
3	20-FL-3495	1	2" Vacuum relief valve
4	20-SS-FL-3520	1	2" NPT threaded nipple, 304 Stainless Steel
5	AT-202-ZS	1	Tee 2" Dia. x 2" FNPT
6	MA-202-ZS	1	2" Dia. NPT to 2" O.D. adapter
7	P-AE-2530	1	Vacuum gauge (Optional)
8	20-CS-FL-3500	1	2" Intake silencer with wire mesh element*

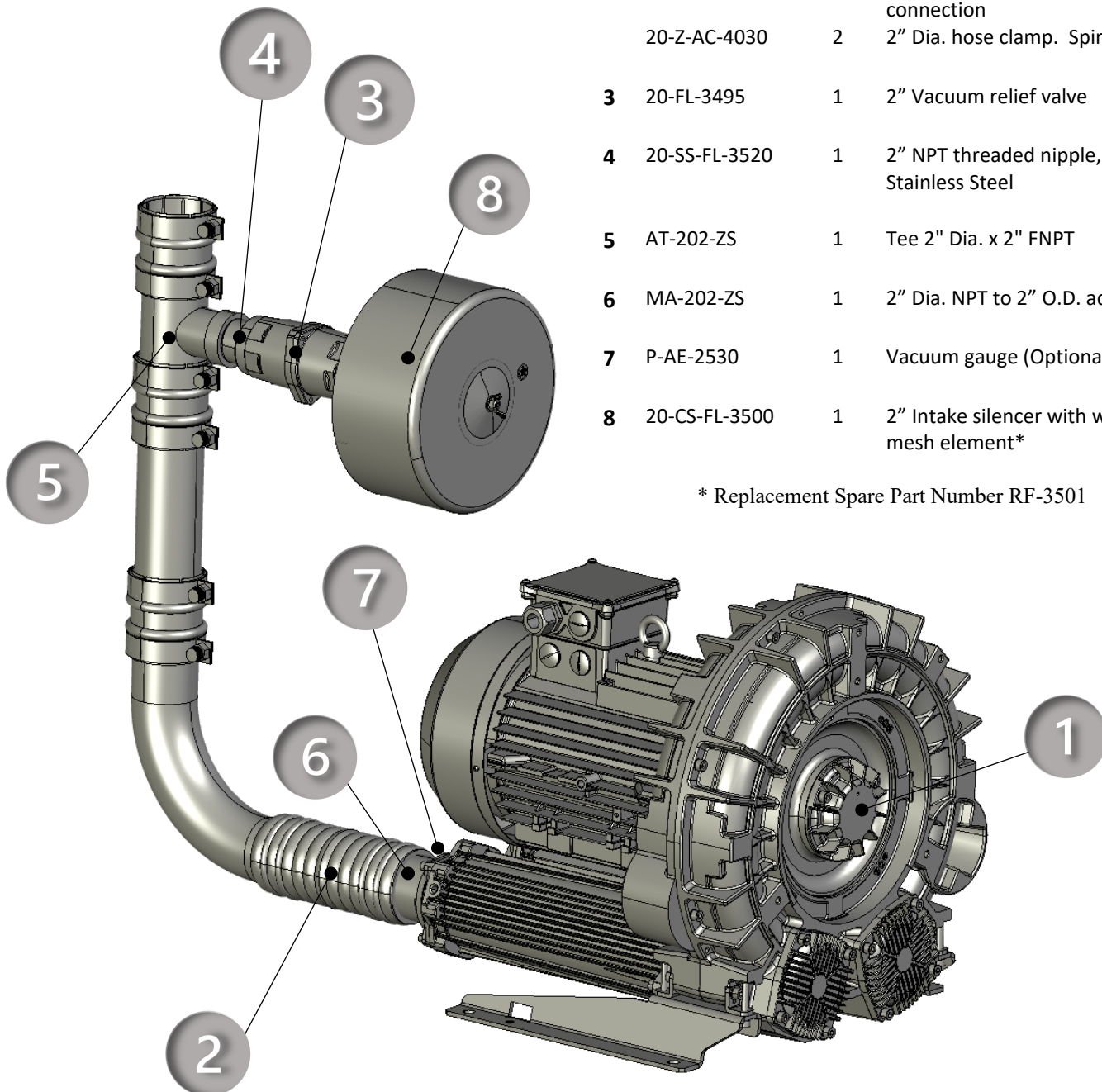

\* Replacement Spare Part Number RF-3501



L-06-MS VACUUM  
PERFORMANCE

CAPACITY

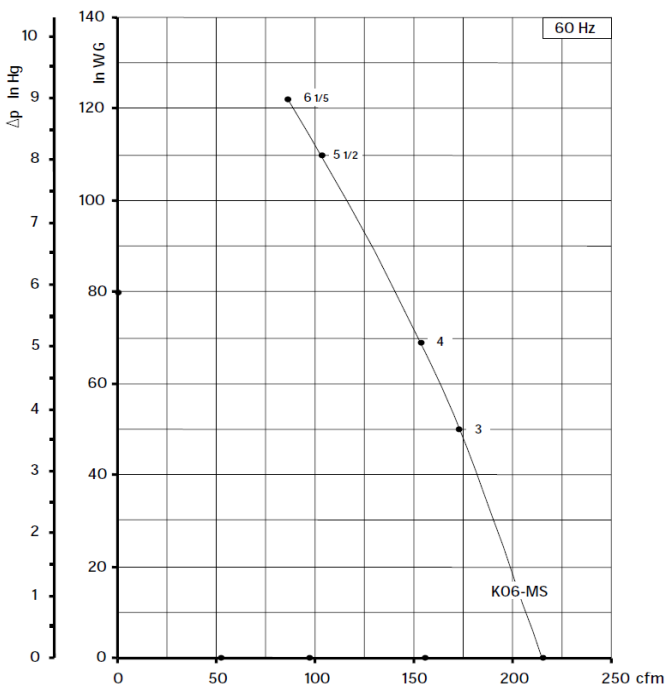

ABSORBED POWER

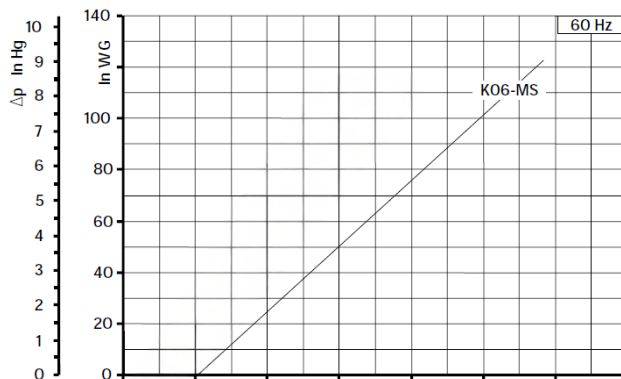

TEMP INCREASE

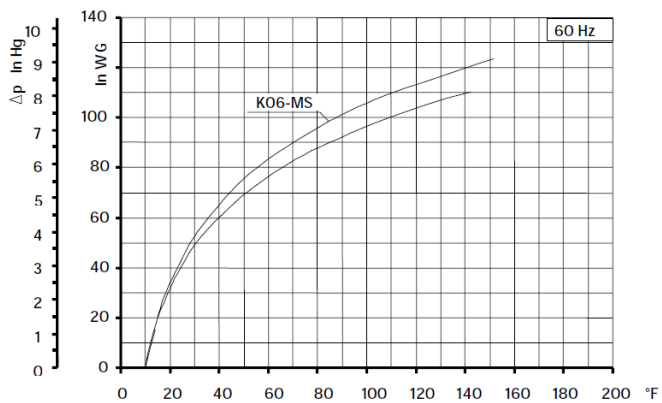

Curves refer to air at 68°F temperature and 29.92 In Hg atmospheric pressure (abs) measured at inlet port. Values for flow, power consumption and temperature rise: +/-10% tolerance. Data subject to change without notice.